

PILLOW BLOCKS

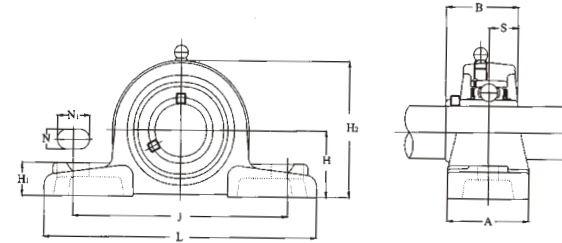

PILLOW BLOCKS



Shaft Diameter (mm)	UNIT Number	Dimensions (mm)										Weight kg
		L	A	J	H1	H	N	N1	H2	B	S	
12	UCP201	127	38	95	15	30.20	13	19	62	31.00	12.70	0.70
15	UCP202	127	38	95	15	30.20	13	19	62	31.00	12.70	0.69
17	UCP203	127	38	95	15	30.20	13	19	62	31.00	12.70	0.68
20	UCP204	127	38	95	15	33.30	13	19	65	31.00	12.70	0.68
25	UCP205	140	38	105	16	36.50	13	19	70	34.10	14.30	0.82
	UCP305	175	45	132	16	45.00	17	20	83	38.00	15.00	1.32
30	UCP206	165	48	121	18	42.90	17	21	83	38.10	15.90	1.36
	UCP306	180	50	140	19	50.00	17	20	94	43.00	17.00	1.82
35	UCP207	167	48	127	19	47.60	17	21	94	42.90	17.50	1.73
	UCP307	210	56	160	21	56.00	17	25	105	48.00	19.00	2.50
40	UCP208	184	54	137	19	49.20	17	23	100	49.20	19.00	2.10
	UCP308	220	60	170	23	60.00	17	27	116	52.00	19.00	3.20
45	UCP209	190	54	146	20	54.00	17	23	108	49.20	19.00	2.20
	UCP309	245	67	190	25	67.00	20	30	128	57.00	22.20	4.30
50	UCP210	206	60	159	22	57.20	20	25	114	51.60	19.00	2.70
	UCP310	275	75	212	28	75.00	20	35	143	61.00	22.00	5.80
55	UCP211	219	60	171	22	63.50	20	25	126	55.60	22.20	3.40
	UCP311	310	80	236	31	80.00	20	38	154	66.00	25.00	7.40
60	UCP212	241	70	184	25	69.80	20	25	138	65.10	25.40	4.80
	UCP312	330	85	250	33	85.00	25	38	165	71.00	26.00	9.00
65	UCP213	265	70	203	27	76.20	25	29	150	65.10	25.40	5.70
	UCP313	340	90	260	36	90.00	25	38	174	75.00	30.00	10.20
70	UCP214	266	72	210	27	79.40	25	31	156	74.60	30.20	6.40
	UCP314	360	90	280	40	95.00	27	40	186	78.00	33.00	12.40
75	UCP215	275	74	217	28	82.60	25	31	163	77.80	33.30	7.20
	UCP315	380	100	290	40	100.00	27	40	197	82.00	32.00	14.60
80	UCP216	292	78	232	30	88.90	25	31	175	82.60	33.30	8.70
	UCP316	400	110	300	45	106.00	27	40	209	86.00	34.00	18.10
85	UCP217	310	83	247	32	95.20	25	31	187	85.70	34.10	11.00
	UCP317	420	110	320	45	112.00	33	45	221	96.00	40.00	21.00
90	UCP218	327	88	262	34	101.60	27	33	200	96.00	39.70	13.30
	UCP318	430	110	330	50	118.00	33	45	233	96.00	40.00	23.00