

Spherical Plain Bearings with Fitting Crack

BPT Spherical Plain Bearings are manufactured with an outer ring with single split in the axial direction, the inner ring with cylindrical extension at either side - 2RS. Both the inner and outer are phosphate treated.

The GEEM type contains lubrication grooves and holes in the outer and inner rings.

The 2RS type is fitted with seal rings on each side.

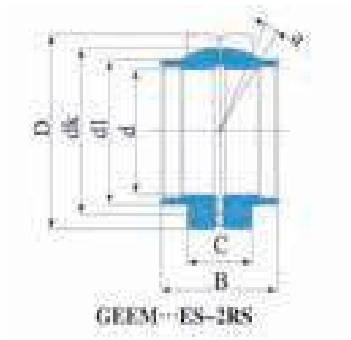

GEEM Radial Wide Inner Ring Series										
Bearing Number	Dimensions (mm)							Load ratings(KN)		Weight (kg)
	d	D	B	C	d1	dk	a° ≈	Dynamic	Static	
GEEM20ES-2RS	20	35	24	12	24	29	6	30	146	0.073
GEEM25ES-2RS	25	42	29	16	29	35.5	4	48	240	0.13
GEEM30ES-2RS	30	47	30	18	34	40.7	4	62	310	0.17
GEEM35ES-2RS	35	55	35	20	40	47	4	79	399	0.25
GEEM40ES-2RS	40	62	38	22	45	53	4	99	495	0.35
GEEM45ES-2RS	45	68	40	25	52	60	4	127	637	0.49
GEEM50ES-2RS	50	75	43	28	57	66	4	156	780	0.6
GEEM60ES-2RS	60	90	54	36	68	80	4	245	1220	1.15
GEEM70ES-2RS	70	105	65	40	78	92	4	313	1560	1.65
GEEM80ES-2RS	80	120	74	45	90	105	4	400	2000	2.5
GEEM90ES-2RS	90	130	80	50	99	115	4	488	2440	2.88
GEEM100ES-2RS	100	150	90	55	113	130	4	607	3030	4.65
GEEM120ES-2RS	120	180	108	70	133	160	4	950	4750	8.44

