

Sprockets



Bearings &
Power Transmission Pty Ltd
(Phone) 07 4636 0522

Contents

SPROCKETS

Chain Tensioners (Idler Sprockets).... 15

see Chains section for details

ASA Plate Wheels 104

40-1 Plate Wheel 104

60-1 Plate Wheel 104

ASA Sprockets 105

25-1 Sprocket 105

35-1 Sprocket 106

40-1 Sprocket 107

60-1 Sprocket 108

80-1 Sprocket 108

BS Sprockets 109

05B Sprocket 109

06B-1-2 Sprocket 110

08B-1-2-3 Sprocket 111

10B-1-2-3 Sprocket 112

12B-1-2-3 Sprocket 113

16B-1-2-3 Sprocket 114

20B-1-2 Sprocket 115

24B-1-2 Sprocket 115

BS Taper Locks 116

06B-1-2 Taper Lock 116

08B-1-2 Taper Lock 116

10B-1-2 Taper Lock 117

12B-1-2-3 Taper Lock 118

16B-1-2-3 Taper Lock 119

BS Plate Wheels 120

06A-1 Plate Wheel 120

08A-1 Plate Wheel 121

10A-1 Plate Wheel 122

12A-1 Plate Wheel 123

16A-1 Plate Wheel 124

Weld Fit Welded Hubs & Sprockets . 125

Welded Hubs 125

ANSI Plate Wheel Sprocket 126

BS Plate Wheel Sprocket 126



ASA Plate Wheels

40-1 Plate Wheel

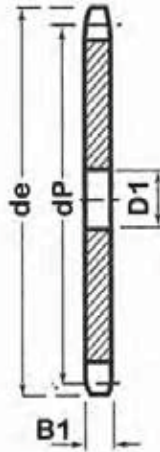
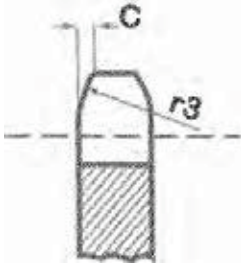

Pinions	mm
Tooth Radius r3	
Radius Width C	
Tooth Width B1	7.2
Chain	mm
Pitch	12.7
Inside	7.92
Roller ø	7.92

Teeth	de	dp	D1	App. Kg
42	176.6	169.95	16	1.13
48	200.8	194.18	20	1.46
50	208.9	202.26	20	1.70
55	229.1	222.46	20	2.08
60	249.3	242.66	20	2.13
65	269.5	262.86	20	2.25
70	289.7	283.07	25	3.28
72	297.8	291.16	25	3.51
76	313.9	307.33	25	3.70

60-1 Plate Wheel

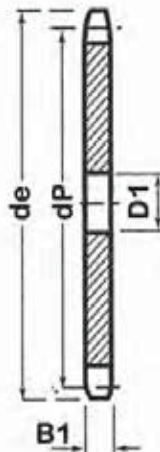
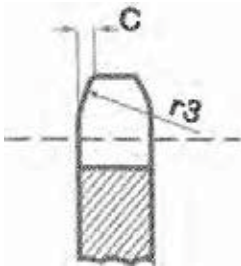

Pinions	mm
Tooth Radius r3	
Radius Width C	
Tooth Width B1	11.7
Chain	mm
Pitch	19.05
Inside	12.7
Roller ø	11.91

Teeth	de	dp	D1	App. Kg
42	265.2	254.93	25	4.53
48	301.5	291.27	25	5.75
50	313.6	303.39	25	6.45
55	343.9	333.70	25	7.82
60	374.2	363.99	25	9.19
65	404.5	394.29	30	10.65
70	434.9	424.60	30	12.45
72	447.0	436.74	30	13.22
76	471.2	460.99	30	14.78

80-1 Plate Wheel

Teeth	de	dp	D1	App. Kg
17	150		20	

Bearings & Power Transmissions stocks a range of ASA high quality steel sprockets. Complete with induction hardened teeth, thus improving the sprockets resistance to wear and increasing the sprockets working life.

All BPT sprockets are engineered in accordance with the stringent ISO 9000 standards.

25-1 Sprocket		Teeth	de	dp	Simplex		
					dm	D1	A
		9	18.1	16.59	10	5	15
		10	22.3	20.55	11	5	15
		11	24.3	22.54	14	6	15
		12	26.4	24.33	16	6	15
		13	28.5	26.53	18	6	15
		14	30.5	28.53	20	6	15
		15	32.5	30.55	22	6	15
		16	34.5	32.55	24	8	15
		17	36.5	34.55	26	8	15
		18	38.5	36.56	28	8	15
		19	40.5	38.58	30	8	15
		20	42.5	40.58	32	8	15
		21	44.6	42.60	34	8	15
		22	46.6	44.62	36	8	15
		23	48.6	46.63	38	8	15
		24	50.6	48.64	40	8	15
		25	52.6	50.66	42	8	18
		26	54.6	52.67	44	10	18
		27	54.6	54.69	46	10	18
		28	58.7	56.71	48	10	18
		29	60.7	58.73	48	10	18
		30	62.7	60.75	48	12	18
		35	72.8	70.84	50	12	18
		38	78.8	76.89	50	12	18
		45	93.0	91.03	0A	0A	0A
		50	104		50	12	20
		57	117.2	115.27	0A	0A	0A
		76	155.6	153.66	0A	0A	0A

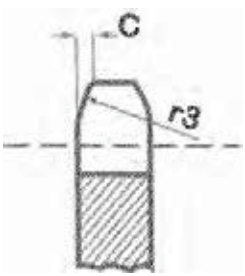
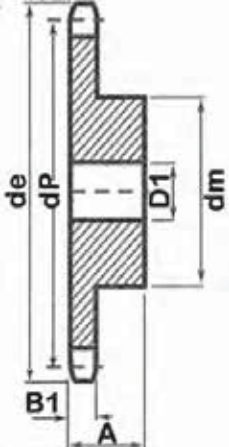
	
Pinions	mm
Tooth Radius r3	
Radius Width C	
Tooth Width B1	2.9
Chain	mm
Pitch	6.35
Inside	3.18
Roller ø	3.3

ASA Sprockets

35-1 Sprocket

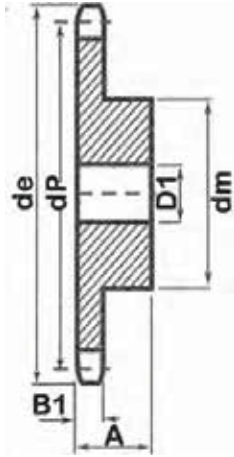
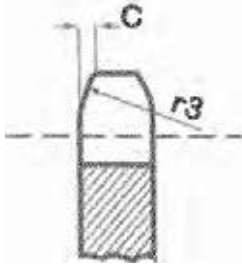

		Teeth	de	dp	Simplex			
					dm	D1	A	App. Kg
		9	28.6	24.89	15	8	20	0.04
		10	31.5	27.85	18	8	20	0.06
		11	34.5	20.82	20	8	20	0.09
		12	40.5	36.8	25	8	25	0.10
		13	43.5	39.80	28	8	25	0.11
		14	46.5	42.80	31	8	25	0.12
		15	49.5	45.81	34	8	25	0.14
		16	52.5	48.82	37	10	28	0.18
		17	55.5	51.83	40	10	28	0.20
		18	58.6	54.85	43	10	28	0.23
		19	61.6	57.87	45	10	28	0.25
		20	64.6	60.89	46	10	28	0.31
		21	67.6	63.91	48	12	28	0.36
		22	70.6	66.93	50	12	28	0.37
		23	73.7	69.95	52	12	28	0.39
		24	76.7	72.97	54	12	28	0.40
		25	79.7	76.00	57	12	28	0.41
		26	82.7	79.02	60	12	28	0.42
		27	85.7	82.04	60	12	28	0.44
		28	88.8	85.07	60	12	28	0.45
		29	91.8	88.09	60	12	28	0.47
		30	94.8	91.12	60	12	28	0.48
		38	119.0	115.34	70	16	30	0.77
		40	125.1	121.40	70	16	30	0.81
		57	177.5	172.91	0A	0A	0A	1.27
		60	186.6	181.99	0A	0A	0A	1.34

Pinions		mm
Tooth Radius r3		
Radius Width C		
Tooth Width B1		4.3

Chain		mm
Pitch		9.525
Inside		4.77
Roller ø		5.08

ASA Sprockets

40-1 Sprocket

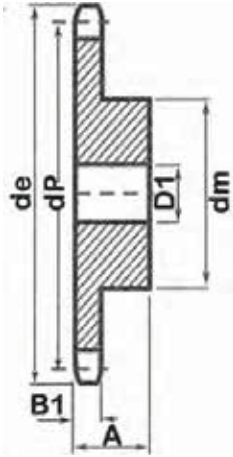
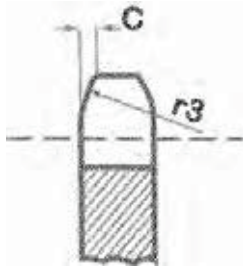

Pinions	mm
Tooth Radius r3	
Radius Width C	
Tooth Width B1	7.2
Chain	mm
Pitch	12.7
Inside	7.94
Roller ø	7.94

Teeth	de	dp	Simplex			
			dm	D1	A	App. Kg
9	43.2	37.13	24	10	25	0.14
10	47.2	41.10	26	10	25	0.15
11	51.2	45.07	29	10	25	0.17
12	55.2	49.07	33	10	28	0.24
13	59.2	53.06	37	10	28	0.25
14	63.2	57.07	41	10	28	0.31
15	67.2	61.09	45	10	28	0.33
16	71.2	65.10	50	12	28	0.37
17	75.2	69.11	52	12	28	0.51
18	79.2	73.14	56	12	28	0.54
19	83.3	77.16	60	12	28	0.65
20	87.3	81.19	64	12	28	0.76
21	91.3	85.22	68	14	28	0.82
22	95.4	89.24	70	14	28	0.88
23	99.4	93.27	70	14	28	1.05
24	103.4	97.29	70	14	28	1.07
25	107.4	101.33	70	14	28	1.13
26	111.5	105.36	70	16	30	1.15
27	115.5	109.40	70	16	30	1.19
28	119.5	113.42	70	16	30	1.30
29	123.6	117.46	80	16	30	1.33
30	127.6	121.50	80	16	30	1.36
32	135.7	129.56	90	16	30	1.46
35	147.8	141.68	90	16	30	1.61
38	159.9	153.80	90	16	35	1.78
40	168.0	161.87	90	16	35	1.88
42	176.6	169.95	0A	0A	0A	1.97
50	208.9	202.26	0A	0A	0A	3.00
55	229.1	222.46	0A	0A	0A	3.14
57	237.2	230.54	0A	0A	0A	3.28
60	249.3	242.66	0A	0A	0A	3.45



ASA Sprockets

60-1 Sprocket

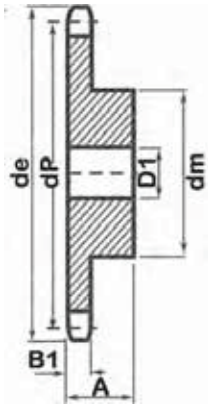
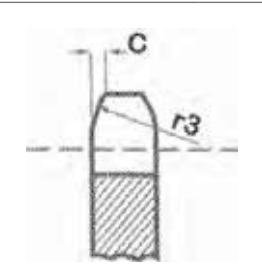

Pinions		mm
Tooth Radius r3		
Radius Width C		
Tooth Width B1		11.6
Chain		mm
Pitch		19.05
Inside		12.7
Roller ø		11.91

Teeth	de	dp	Simplex			
			dm	D1	A	App. Kg
9	64.0	55.70	37	12	30	0.35
10	70.0	61.64	42	12	30	0.41
11	76.0	67.61	46	16	35	0.53
12	81.9	73.6	52	16	35	0.67
13	87.9	79.59	58	16	35	0.75
14	94.0	85.61	64	16	35	0.91
15	100.0	91.63	70	16	35	1.14
16	106.0	97.65	75	16	35	1.27
17	112.0	103.67	80	16	35	1.46
18	118.0	109.71	80	16	35	1.69
19	124.1	115.75	80	16	35	1.78
20	130.1	121.78	80	16	35	2.10
21	136.2	127.82	90	20	40	2.27
22	142.2	133.86	90	20	40	2.38
23	148.2	139.90	90	20	40	2.49
24	154.3	145.94	90	20	40	2.62
25	160.3	152.00	90	20	40	2.78
26	166.4	158.04	95	20	40	2.89
27	172.4	164.09	95	20	40	3.05
28	178.5	170.13	95	20	40	3.12
29	184.5	176.19	95	20	40	3.30
30	190.6	182.25	95	20	40	3.44
32	202.7	194.35	95	20	40	3.75
34	214.8	206.46	95	0A	40	3.99
38	239.0	230.69	100	25	40	4.92
40	251.1	242.81	100	25	0A	5.22

80-1 Sprocket

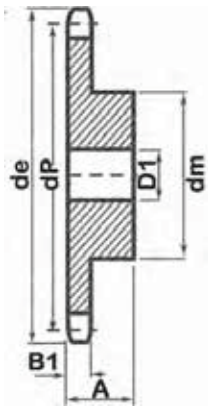
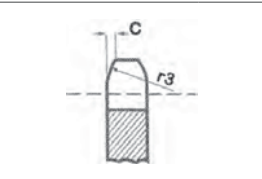

Pinions		mm
Tooth Radius r3		
Radius Width C		
Tooth Width B1		14.6
Tooth Width b1		
Tooth Width B2		
Tooth Width B3		
Chain		mm
Pitch		25.4
Inside		15.88
Roller ø		15.88

Teeth	de	dp	Simplex			
			dm	D1	A	App. Kg
9	85.8	72.47	50	16	35	0A
10	93.8	78.49	55	16	35	0A
11	101.7	84.51	61	16	40	1.45
12	109.7	90.54	69	16	40	1.82
13	117.7	96.57	78	16	40	1.92
14	125.7	102.60	84	16	40	2.09
15	133.7	108.63	92	16	40	2.59
16	141.8	114.66	100	20	45	3.00
17	149.8	120.69	100	20	45	3.18
18	157.8	126.72	100	20	45	3.77
19	165.9	132.75	100	20	45	3.86
20	173.9	138.78	100	20	45	4.09
21	182.0	144.81	110	20	50	4.54
22	190.1	150.84	110	20	50	4.99
23	198.1	156.87	110	20	50	5.08
24	208	162.90	108	25	45	0A
25	215	168.93	110	20	50	0A
26	224	174.96	108	25	45	0A
27	230	180.99	120	20	50	0A
28	237	187.02	120	20	50	0A
29	245	193.05	108	25	45	0A
30	255	199.08	108	25	45	0A
38	319.2	267.59	120	25	50	11.12

British Standard Sprockets

Bearings & Power Transmissions stocks a range of British high quality steel sprockets. Complete with induction hardened teeth, thus improving the sprockets resistance to wear and increasing the sprockets working life.

All BPT sprockets are engineered in accordance with the stringent ISO 9000 standards.

05B Sprocket		Teeth	de	dp	Simplex		
					dm	D1	A
		9	25.09	23.99	15	6	12
		10	28.4	25.89	17	6	12
		11	31	28.39	18	7	13
		12	33.7	30.91	20	7	13
		13	36.7	33.42	23	7	13
		14	39.2	35.95	25	7	13
		15	41.7	48.48	28	7	13
		16	44.2	41.01	30	8	14
		17	46.7	43.53	30	8	14
		18	49.2	46.07	30	8	14
		19	51.7	48.61	30	8	14
		20	54.2	51.14	30	8	14
		21	57.2	53.67	35	8	14
		22	59.2	56.21	35	8	14
		23	62.2	58.75	35	8	14
		24	64.7	61.29	35	8	14
		25	67.2	63.83	35	8	14
		26	69.7	66.37	40	10	16
		27	72.3	68.91	40	10	16
		28	74.7	71.45	40	10	16
		30	80.2	76.53	40	10	16
		38	100.2	96.88	40	12	16
		57	149.3	145.2	80	14	20

Pinions		mm
Tooth Radius r3		
Radius Width C		
Tooth Width B1	2.8	
Tooth Width b1		

Chain		mm
Pitch	8	
Inside	3	
Roller ø	5	

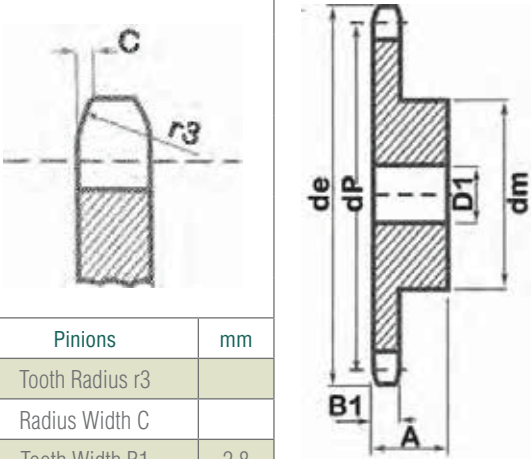



British Standard Sprockets

06B-1-2 Sprocket

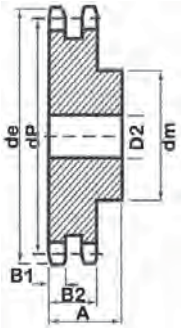
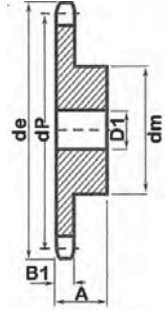
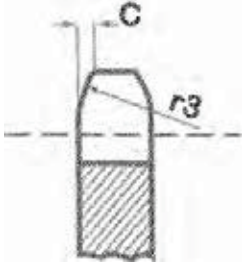

Pinions		mm
Tooth Radius r3		
Radius Width C		
Tooth Width B1	5.3	
Tooth Width b1		
Tooth Width B2	15.4	
Chain		mm
Pitch	9.53	
Inside	5.72	
Roller ø	6.35	

Teeth	de	dp	Simplex				Duplex			
			dm	D1	A	App. Kg	dm	D2	A	App. Kg
8	28.6	24.89	15	8	20	0.03				
9	31.5	27.85	18	8	20	0.04	18	8	25	
10	34.5	30.82	20	8	20	0.06	20	8	25	0.11
11	37.5	33.8	22	8	25	0.09	22	10	30	0.13
12	40.5	36.8	25	8	25	0.10	25	10	30	0.16
13	43.5	39.8	28	8	25	0.11	28	10	30	0.20
14	46.5	42.8	31	8	25	0.12	31	10	30	0.25
15	49.5	45.81	34	8	25	0.14	34	10	30	0.29
16	52.5	48.82	37	10	28	0.18	37	12	30	0.34
17	55.5	51.83	40	10	28	0.20	40	12	30	0.39
18	58.6	54.85	43	10	28	0.23	43	12	30	0.45
19	61.6	57.87	45	10	28	0.25	46	12	30	0.52
20	64.6	60.89	46	10	28	0.31	49	12	30	0.59
21	67.6	63.91	48	12	28	0.36	52	16	30	0.68
22	70.6	66.93	50	12	28	0.37	55	16	30	0.75
23	73.7	69.95	52	12	28	0.39	58	16	30	0.80
24	76.7	72.97	54	12	28	0.40	61	16	30	0.84
25	79.7	76	57	12	28	0.41	64	16	30	0.89
26	82.7	79.02	60	12	28	0.42	67	16	30	0.91
27	85.7	82.04	60	12	28	0.44	70	16	30	1.00
28	88.8	85.07	60	12	28	0.45	73	16	30	1.07
29	91.8	88.09	60	12	28	0.47	76	16	30	1.14
30	94.8	91.12	60	12	28	0.48	79	16	30	1.22
31	97.9	94.15	65	14	30	0.51				
32	100.9	97.17	65	14	30	0.56				
33	103.9	100.2	65	14	30	0.62				
34	106.9	103.2	65	14	30	0.66				
35	110	106.3	65	14	30	0.68				
36	113	109.3	70	16	30	0.71				
37	116	112.3	70	16	30	0.74				
38	119	115.3	70	16	30	0.77	90	16	30	1.72
39	122.1	118.4	70	16	30	0.79				
40	125.1	121.4	70	16	30	0.81				
45	140.2	136.5	75	16	30	0.91	90	19	35	2.35
57	176.6	172.9	75	19	30	1.27	90	19	35	3.47
76	234.2	230.5	75	19	30	1.91	90	19	38	5.67
95	291.8	288.1	75	19	30	2.61	95	25	38	8.64
114	349.4	345.7	75	19	30	3.63	95	25	38	11.12

British Standard Sprockets

08B-1-2-3 Sprocket			Teeth	de	dp	Simplex				Duplex				Triplex				
						dm	D1	A	App. Kg	dm	D2	A	App. Kg	dm	D3	A	App. Kg	
			8	38	33.18	20	10	25	0.13									
			9	42	37.13	24	10	25	0.14	24	10	32	0.18					
			10	45.9	41.1	26	10	25	0.15	28	10	32	0.22					
			11	49.9	45.07	29	10	25	0.17	32	12	35	0.24					
			12	53.9	49.07	33	10	28	0.24	35	12	35	0.26					
			13	57.9	53.06	37	10	28	0.25	38	12	35	0.28	38	16	50	0.59	
			14	61.9	57.07	41	10	28	0.31	42	12	35	0.34	42	16	50	0.72	
			15	65.9	61.09	45	10	28	0.33	46	12	35	0.36	46	16	50	0.81	
			16	69.9	65.1	50	12	28	0.37	50	16	38	0.40	50	16	50	0.90	
			17	74	69.11	52	12	28	0.51	54	16	38	0.44	54	16	50	1.04	
			18	78	73.14	56	12	28	0.54	58	16	38	0.49	58	16	50	1.22	
			19	82	77.16	60	12	28	0.65	62	16	38	0.57	62	16	50	1.41	
			20	86	81.19	64	12	28	0.76	66	16	38	0.65	66	16	50	1.58	
			21	90.1	85.22	68	14	28	0.82	70	16	40	0.72	70	16	55	1.81	
			22	94.1	89.24	70	14	28	0.88	70	16	40	0.80	70	16	55	2.03	
			23	98.1	93.27	70	14	28	1.05	70	16	40	0.83	70	16	55	2.27	
			24	102.1	97.29	70	14	28	1.07	75	16	40	0.94	75	16	55	2.44	
			25	106.2	101.3	70	14	28	1.13	80	16	40	0.98	80	16	55	2.54	
			26	110.2	105.4	70	16	30	1.15	85	16	40	1.04	85	20	55	OA	
			27	114.2	109.4	70	16	30	1.19	85	16	40	1.08	85	20	55	2.85	
			28	118.3	113.4	70	16	30	1.30	90	16	40	1.10	90	20	55	3.16	
			29	121		80	11	30	OA	OA	OA	OA	OA	95	20	55	OA	
			30	126.3	121.5	80	16	30	1.36	100	16	40	1.16	95	20	55	3.48	
			31	130.4	125.5	90	16	30	1.41									
			32	134.4	129.6	90	16	30	1.46	100	20	40	1.24					
			33	138.4	133.6	90	16	30	1.51									
			34	142.5	137.6	90	16	30	1.56	100	20	40	1.33					
			35	146.5	141.7	90	16	30	1.61									
			36	150.6	145.7	90	16	35	1.69	100	20	40	2.05					
			37	154.6	149.8	90	16	35	1.74									
			38	158.6	153.8	90	16	35	1.78	100	20	40	2.17	120	25	55	6.49	
			39	162.7	157.8	90	16	35	1.83									
			40	166.7	161.9	90	16	35	1.88	100	20	40	2.28					
			41	171						OA	OA	OA						
			42	176.5	170	90	19	35	1.97	110	20	45	2.32					
			43	179						OA	OA	OA						
			44	185						OA	OA	OA						
			45	188.6	182.1	90	19	35	2.11	110	20	45	2.49					
			46	193						OA	OA	OA						
			48	200.7	194.2	100	19	35	2.76	110	20	45	2.65					
			50	208.8	202.3	OA	OA	OA	2.90	OA	OA	OA						
			55	229	222.5	OA	OA	OA	3.15									
			57	233.1	230.5	100	19	35	3.28	110	25	45	3.88	120	25	60	12.62	
			60	249.2	242.7	100	19	35	3.45									
			76	313.9	307.3	100	19	35	5.73	120	30	45	6.60	130	30	65	22.23	
			95	390.7	384.1	100	25	35	8.90	120	30	45	9.89					
			114	467.4	460.9	100	25	35	11.17	120	30	45	12.88					

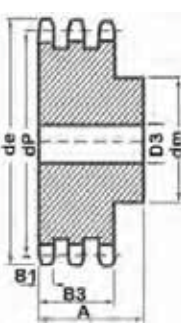
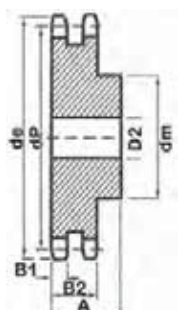
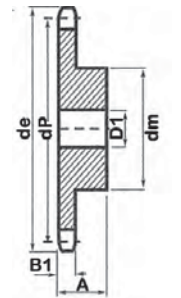
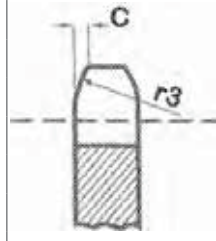

Pinions	mm
Tooth Radius r3	
Radius Width C	
Tooth Width B1	7.2
Tooth Width b1	
Tooth Width B2	21
Tooth Width B3	34.9
Chain	mm
Pitch	12.7
Inside	7.75
Roller ø	8.51

British Standard Sprockets

SPROCKETS

10B-1-2-3 Sprocket

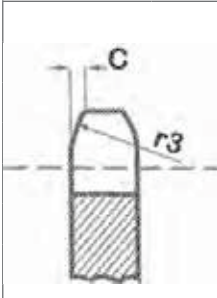

Pinions	mm
Tooth Radius r3	
Radius Width C	
Tooth Width B1	9.1
Tooth Width b1	
Tooth Width B2	25.5
Tooth Width B3	
Chain	mm
Pitch	5.88
Inside	9.65
Roller ø	10.2

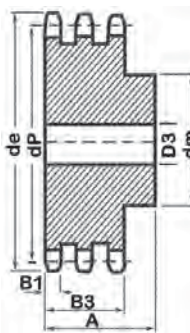
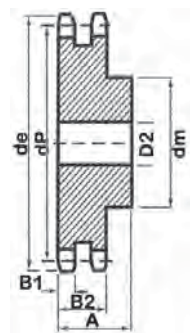
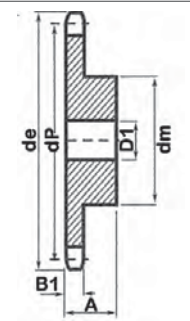

Teeth	de	dp	Simplex				Duplex			
			dm	D1	A	App. Kg	dm	D2	A	App. Kg
8	48.4	41.48	25	10	25	0.09				
9	53.3	46.42	30	10	25	0.14	30	12	40	0.31
10	58.3	51.37	35	10	25	0.23	35	12	40	0.39
11	63.2	56.35	37	12	30	0.27	39	16	40	0.44
12	68.2	61.34	42	12	30	0.32	44	16	40	0.57
13	73.2	66.32	47	12	30	0.36	49	16	40	0.71
14	78.2	71.34	52	12	30	0.45	54	16	40	0.84
15	83.2	76.36	57	12	30	0.59	59	16	40	1.01
16	88.3	81.37	60	12	30	0.68	64	16	45	1.19
17	93.3	86.39	60	12	30	0.82	69	16	45	1.38
18	98.3	91.42	70	14	30	0.91	74	16	45	1.62
19	103.3	96.45	70	14	30	1.04	79	16	45	1.77
20	108.4	101.5	75	14	30	1.13	84	16	45	1.93
21	113.4	106.5	75	16	30	1.18	85	20	45	2.22
22	118.4	111.6	80	16	30	1.27	90	20	45	2.53
23	123.5	116.6	80	16	30	1.45	95	20	45	2.77
24	128.5	121.6	80	16	30	1.50	100	20	45	2.95
25	133.6	126.7	80	16	30	1.59	105	20	45	3.15
26	138.6	131.7	85	20	35	1.63	110	20	45	3.42
27	143.6	136.8	85	20	35	1.68	110	20	45	3.98
28	148.7	141.8	90	20	35	1.72	115	20	45	4.2
29	153.7	146.8	90	20	35	1.91	115	20	45	4.43
30	158.8	151.9	90	20	35	2.04	120	20	45	4.66
31	163.8	156.9	95	20	35	2.13				
32	168.9	162	95	20	35	2.27				
33	173.9	167	95	20	35	2.33				
34	178.9	172.1	95	20	35	2.36				
35	184	177.1	95	20	35	2.48				
36	189	182.2	100	20	35	2.56				
37	194.1	187.2	100	20	35	2.68				
38	199.1	192.2	100	20	35	2.72	120	20	45	7.67
39	204.2	197.3	100	20	35	2.86				
40	209.2	202.3	100	20	35	2.95	120	20	45	7.92
42	220.8	212.4	OA	OA	OA	3.01				
45	236	227.6	OA	OA	OA	3.73	OA	OA	OA	9.21
48	251.1	242.7	OA	OA	OA	4.18				
50	261.2	252.8	OA	OA	OA	4.40				
55	286.5	278.1	OA	OA	OA	4.96				
57	296.6	288.2	OA	OA	OA	5.27	OA	OA	OA	15.07
60	311.7	303.3	OA	OA	OA	5.9				
76	392.5	384.2	OA	OA	OA	11.03	OA	OA	OA	26.31
95	488.5	480.1	OA	OA	OA	14.57	OA	OA	OA	32.69
114	584.5	576.1	OA	OA	OA	20.61	OA	OA	OA	49.3

www.bpt.net.au | Bearings & Power Transmission Pty Ltd

British Standard Sprockets

12B-1-2-3 Sprocket			Teeth	de	dp	Simplex				Duplex				Triplex				
						dm	D1	A	App. Kg	dm	D2	A	App. Kg	dm	D3	A	App. Kg	
			8	58	49.78	31	12	30										
			9	63.9	55.7	37	12	30		37	16	45	0.75					
			10	69.8	61.64	42	12	30		42	16	45	0.90					
			11	75.8	67.61	46	16	35	0.53	47	16	50	1.00					
			12	81.8	73.6	52	16	35	0.67	53	16	50	1.23					
			13	87.8	79.59	58	16	35	0.75	59	16	50	1.41	59	20	70	1.77	
			14	93.8	85.61	64	16	35	0.91	65	20	50	1.68					
			15	99.8	91.63	70	16	35	1.14	71	20	50	1.95	71	20	70	2.45	
			16	105.8	97.65	75	16	35	1.27	77	20	50	2.27					
			17	111.9	103.7	80	16	35	1.46	83	20	50	2.63	83	20	70	3.49	
			18	117.9	109.7	80	16	35	1.69	89	20	50	3.18					
			19	123.9	115.8	80	16	35	1.78	95	20	50	3.50	95	20	70	4.54	
			20	130	121.8	80	16	35	2.10	100	20	50	3.72					
			21	136	127.8	90	20	40	2.27	100	20	50	4.31	100	25	70	5.67	
			22	142	133.9	90	20	40	2.38	100	20	50	4.77					
			23	148.1	139.9	90	20	40	2.49	110	20	50	4.99	110	25	70	6.62	
			24	154.1	145.9	90	20	40	2.62	110	20	50	5.45					
			25	160.2	152	90	20	40	2.78	120	20	50	5.67	120	25	70	7.71	
			26	166.2	158	95	20	40	2.89	120	20	50	6.13					
			27	172.3	164.1	95	20	40	3.05	120	20	50	6.49	120	25	70	8.99	
			28	178.3	170.1	95	20	40	3.12	120	20	50	6.81					
			29	184.4	176.2	95	20	40	3.30	120	20	50	7.13					
			30	190.4	182.3	95	20	40	3.44	120	20	50	7.49	120	25	70	10.53	
			31	196.5	188.3	95	20	40	3.50									
			32	202.5	194.4	95	20	40	3.75									
			33	208.6	200.4	95	20	40	3.82									
			34	214.6	206.5	95	20	40	3.99									
			35	220.7	212.5	95	20	40	4.10	120	20	50	10.18					
			36	226.8	218.6	100	25	40	4.35	120	25	50	12.31					
			37	232.8	224.6	100	25	40	4.64									
			38	238.9	230.1	100	25	40	4.92	120	25	50	12.99	130	25	70	20.57	
			39	244.9	236.8	100	25	40	5.15									
			40	251	242.8	100	25	40	5.22									
			41	258		100	25	40	OA									
			42	265	254.9	OA	OA	OA	5.78									
			43	272		100	25	40	OA									
			44	276		100	25	40	OA									
			45	283.2	273.1	OA	OA	OA	6.34	OA	OA	OA	15.38					
			48	301.4	291.3	OA	OA	OA	7.18									
			50	313.5	303.4	OA	OA	OA	8.01									
			55	343.8	333.7	OA	OA	OA	9.90									
			57*	355.9	345.8	OA	OA	OA	10.10	OA	OA	OA	25.34	OA	OA	OA	33.73	
			60	374.1	364	OA	OA	OA	11.44									
			76*	471.1	461	OA	OA	OA	17.26	OA	OA	OA	25.63	OA	OA	OA	37.19	
			95	586.2	576.2	OA	OA	OA	23.83	OA	OA	OA	39.24					
			114	OA		OA	OA	OA	OA									

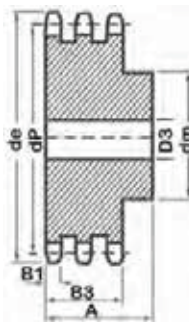
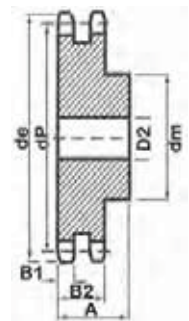
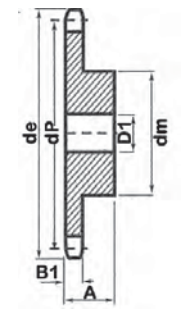
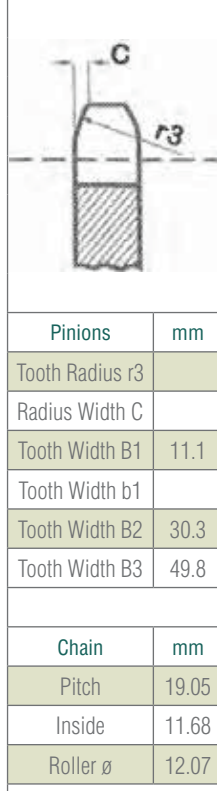

British Standard Sprockets

16B-1-2-3 Sprocket

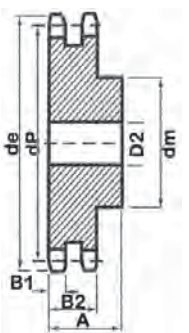
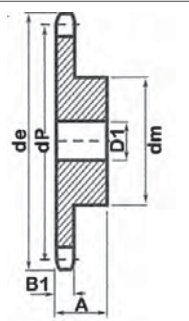
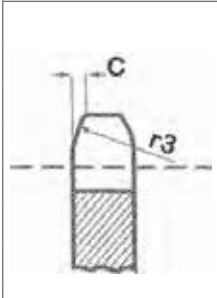

Pinions	mm
Tooth Radius r3	
Radius Width C	
Tooth Width B1	16.2
Tooth Width b1	
Tooth Width B2	47.7
Tooth Width B3	79.6
Chain	
Pitch	25.4
Inside	17
Roller ø	15.88

Teeth	de	dp	Simplex				Duplex				Triplex					
			dm	D1	A	App. Kg	dm	D2	A	App. Kg	dm	D3	A	App. Kg		
8	77.9	66.37	42	16	35	0.95										
9	85.8	74.27	50	16	35	1.20	50	20	65							
10	93.8	82.19	55	16	35	1.35	56	20	65							
11	101.7	90.14	61	16	40	1.45	64	20	70	1.82						
12	109.7	98.14	69	16	40	1.82	72	20	70	2.36						
13	117.7	106.1	78	16	40	1.94	80	20	70	1.95	80	25	100	4.13		
14	125.7	114.2	84	16	40	2.09	88	20	70	3.5						
15	133.7	122.2	92	16	40	2.59	96	20	70	4.18	96	25	100	5.54		
16	141.8	130.2	100	20	45	3.00	104	25	70	5.22						
17	149.8	138.2	100	20	45	3.18	112	25	70	5.99	112	25	100	8.07		
18	157.8	146.3	100	20	45	3.77	120	25	70	6.81						
19	165.9	154.4	100	20	45	3.86	128	25	70	7.71	128	25	100	10.89		
20	173.9	162.4	100	20	45	4.09	130	25	70	8.26						
21	182	170.4	110	20	50	4.54	130	25	70	8.85	130	25	100	13.61		
22	190.1	178.5	110	20	50	5.00	130	25	70	9.53						
23	198.1	186.5	110	20	50	5.08	130	25	70	10.43	130	25	100	14.97		
24	206.2	194.6	110	20	50	5.54	130	25	70	11.44						
25	214.2	202.7	110	20	50	5.76	130	25	70	12.47	130	25	100	17.70		
26	222.3	210.7	120	20	50	7.03	130	25	70	13.62						
27	230.4	218.8	120	20	50	7.53	130	25	70	14.75	130	30	100	21.57		
28	238.4	226.9	120	20	50	7.58	130	25	70	15.89						
29	246.5	234.9	120	20	50	7.94	130	25	70	17.02						
30	254.6	243	120	20	50	8.26	130	25	70	18.16	130	30	100	26.33		
31	262.6	251.1	120	25	50	8.62										
32	270.7	259.1	120	25	50	8.98										
33	278.8	267.2	120	25	50	9.33										
34	286.9	275.3	120	25	50	9.69										
35	294.9	283.4	120	25	50	10.05										
36	303	291.4	120	25	50	10.41										
37	311.1	299.5	120	25	50	10.78										
38	319.2	307.6	120	25	50	11.12	140	25	70	29.60	140	30	100	41.45		
39	327.2	315.7	120	25	50	11.48										
40	335.3	323.4	120	25	50	11.83										
45	377.9	364.1	OA	OA	OA	13.62	OA	OA	OA	34.35	OA	OA	OA	45.00		
57*	474.9	461.1	OA	OA	OA	22.16	OA	OA	OA	38.18	OA	OA	OA	51.35		
76*	628.4	614.7	OA	OA	OA	39.24	OA	OA	OA	68.11	OA	OA	OA	77.11		
95	782	768.2	OA	OA	OA	57.12										
114	935.6	921.8	OA	OA	OA	75.00										

British Standard Sprockets



Bearings &
Power Transmission Pty Ltd
(Phone) 07 4636 0522

SPROCKETS

20B-1-2 Sprocket		Teeth	de	dp	Simplex				Duplex			
					dm	D1	A	App. Kg	dm	D2	A	App. Kg
		9	106.5	92.84	63	20	40	1.45				
		10	117	102.7	70	20	40	1.86				
		11	127	112.7	77	20	45	2.40	80	25	80	3.67
		12	137	122.7	88	20	45	2.95	90	25	80	0A
		13	147.5	132.7	98	20	45	3.00	100	25	80	5.53
		14	157.6	142.7	108	20	45	3.40	110	25	80	6.62
		15	167.6	152.7	118	20	45	4.31	120	25	80	7.76
		16	177.7	162.8	120	25	50	4.63	120	30	80	0A
		17	187.8	172.8	120	25	50	4.99	120	30	80	10.44
		18	197.8	182.9	120	25	50	5.44	120	30	80	0A
		19	207.9	192.9	120	25	50	5.9	120	30	80	12.92
		20	217.9	203	120	25	50	6.35	120	30	80	0A
		21	228	213	140	30	55	7.03	140	30	80	16.55
		22	238.1	223.1	140	30	55	7.71	140	30	80	0A
		23	248.2	233.2	140	30	55	8.16	140	30	80	19.05
		24	258.3	243.2	140	30	55	8.62	140	30	80	0A
		25	268.4	253.3	140	30	55	9.07	140	30	80	21.77
		26	278.4	263.4	150	30	55	9.53	150	30	80	0A
		27	288.5	273.5	150	30	55	10.43	150	30	80	24.97
		28	299	283.6	0A	0A	0A	11.34	150	30	80	0A
		30	319	303.8	0A	0A	0A	12.02	150	30	80	0A

24B-1-2 Sprocket		Teeth	de	dp	Simplex				Duplex			
					dm	D1	A	App. Kg	dm	D2	A	App. Kg
		9	125	111.4	70	25	95	2.02				
		10	137	123.3	80	25	95	2.61				
		11	149	135.2	90	25	100	3.77	90	25	100	6.50
		12	161	147.2	102	25	100	4.77	102	25	0A	0A
		13	137	159.2	114	25	100	5.91	114	25	100	9.92
		14	185	171.2	128	25	100	6.68	128	25	100	11.98
		15	197	183.3	132	25	100	7.49	132	25	100	14.13
		16	209	195.3	136	30	100	9.08	136	30	100	16.35
		17	221	207.3	136	30	100	9.76	136	30	100	17.85
		18	233	219.4	160	30	100	10.49	160	30	100	20.35
		19	245.5	231.5	160	30	100	11.21	160	30	100	22.56
		20	257.5	243.6	160	30	100	12.26	160	30	100	24.78
		21	270.5	255.7	160	30	100	13.38	160	30	100	26.99
		22	282.5	267.7	160	30	100	13.67	160	30	100	29.74
		23	294.5	279.8	160	30	100	14.74	0A	0A	0A	0A
		24	307	292	0A	0A	0A	0A	0A	0A	0A	0A
		25	319	304	160	30	100	16.38	0A	0A	0A	0A
		26	331	317	0A	0A	0A	0A	0A	0A	0A	0A
		27	343	328	0A	0A	0A	0A	0A	0A	0A	0A
		28	355	340	0A	0A	0A	0A	0A	0A	0A	0A
		29	367	352	0A	0A	0A	0A	0A	0A	0A	0A
		30	379	365	0A	0A	0A	0A	0A	0A	0A	0A

British Standard Taper Locks

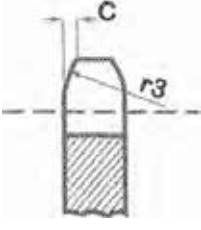
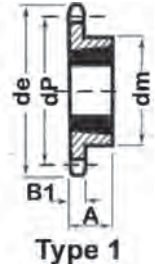
06B-1-2 Taper Lock		Teeth	de	dp	Simplex				Duplex					
					dm	A	Bush	Type	App. Kg	dm	A	Bush	Type	App. Kg
		17	55.5	51.83	45	22.23	1008	1	0.14	41	22	1008	2	0.5
		18	58.6	54.85	45	22.23	1008	1	0.18	43	22	1008	2	0A
		19	61.6	57.87	45	22.23	1008	1	0.23	46	22	1008	2	0.6
		20	64.6	60.89	45	22.23	1008	1	0.27	48	22	1008	2	0A
		21	67.6	63.91	45	22.23	1008	1	0.32	49	22	1008	2	1.4
		22	70.6	66.93	45	22.23	1008	1	0.36	52	22	1008	2	0A
		23	73.7	69.95	63	25.40	1210	1	0.41	59	25	1210	2	1.8
		24	76.7	72.97	63	25.40	1210	1	0.45	61	25	1210	2	0A
		25	79.7	76	63	25.40	1210	1	0.54	64	25	1210	2	1.9
		26	83	79.02	63	0A	1210	0A	0A	0A	0A	1210	0A	0A
		27	85.7	82.04	63	25.40	1210	1	0.52	70	25	1210	2	2.0
		28	89	85.07	63	0A	1210	0A	0A	0A	0A	1210	0A	0A
		29	0A	0A	63	25.40	1210	0A	0A	0A	0A	1210	0A	0A
		30	94.8	91.12	63	25.40	1210	1	0.54	75	25	1210	2	2.1
		36	113							80	25	1610	0A	0A
		38	119	115.3	70	25.40	1210	1	0.68	80	25	1610	2	2.5
		45	118.6	114.7	70	25.40	1210	1	0.95					
		57	149.3	145.2	83	25.40	1210	1	1.25	92	25	1610	2	4.1
		76	197.9	193.6	83	25.40	1210	1	1.82	0A	0A	1615	2	6.8
		95	246.3	242	83	25.40	1210	1	2.28	0A	0A	1615	2	6.9
		114	294.8	290.3	0A	0A	1610	0A	0A					

Pinions	mm
Tooth Radius r3	
Radius Width C	
Tooth Width B1	5.3
Chain	mm
Pitch	9.53
Inside	5.72
Roller ø	6.35

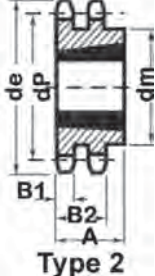

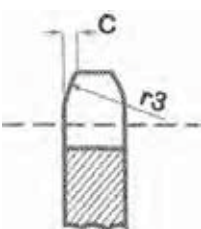
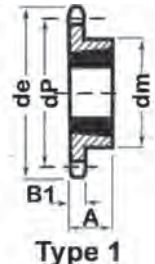
08B-1-2 Taper Lock		Teeth	de	dp	Simplex				Duplex					
					dm	A	Bush	Type	App. Kg	dm	A	Bush	Type	App. Kg
		15	65.9	61.09	45	22.23	1008	1	0.18	46	22.23	1008	2	0.18
		16	69.9	65.1	45	22.23	1008/1108	1	0.23	50	22	1008	2	0A
		17	74	69.11	60	25.40	1210	1	0.23	56	25.40	1210	2	0.27
		18	78	73.14	62	25.40	1210	1	0.27	60	25	1210	2	
		19	82	77.16	63	25.40	1210	1	0.32	62	25.40	1210	2	0.36
		20	86	81.19	71	25.40	1210/1610	1	0.41	66	25	1610	2	0A
		21	90.1	85.22	71	25.40	1610	1	0.45	70	25.40	1610	2	0.46
		22	94.1	89.24	71	25.40	1610	1	0.50	76	25	1610	2	0A
		23	98.1	93.27	76	25.40	1610	1	0.59	79	25.40	1610	2	0.59
		24	102.1	97.29	76	25.40	1610	1	0.73	84	25	2012	2	0A
		25	106.2	101.3	76	25.40	1610	1	0.74	87	31.75	2012	2	0.77
		26	110.2	105.4	76	25.40	1610	1	0.76	87	32	2012	2	0A
		27	114.2	109.4	76	25.40	1610	1	0.78	87	31.75	2012	2	0.95
		28	118.3	113.4	76	25.40	1610	1	0.80	87	32	2012	2	0A
		29	112.3	117.5	76	25.40	1610	1	0.81	0A	0A	2012	2	0A
		30	126.3	121.5	90	31.75	2012	1	0.82	87	31.75	2012	2	1.59
		32	134.4	129.6	90	31.75	2012	1	0.87					
		37								0A	0A	2012	2	2.85
		38	158.6	153.8	90	31.75	2012	1	1.23	100	32	2012	2	3.18
		45	188.6	182.1	100	31.75	2012	1	1.46					
		48	200.7	194.2	100	31.75	2012	1	1.55					
		57	233.1	230.5	110	31.75	2012	1	2.60	110	31.75	2012	2	7.56
		76	313.9	307.3	110	31.75	2012	1	4.27	110	31.75	2012	2	15.26
		95	390.7	384.1	110	31.75	2012	1	6.88	110	31.75	2012	2	19.08
		114	467.4	460.9	110	44.45	2517	1	10.44	0A	0A	2517	2	22.90

Pinions	mm
Tooth Radius r3	
Radius Width C	
Tooth Width B1	7.2
Chain	mm
Pitch	12.7
Inside	7.75
Roller ø	8.51

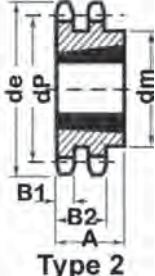

British Standard Taper Locks

10B-1-2 Taper Lock		Teeth	de	dp	Simplex				Duplex					
					dm	A	Bush	Type	App. Kg	dm	A	Bush	Type	App. Kg
		13	73.2	66.32	47	22.23	1008	1	0.23					
		14	78	71.44	52	22.23	1108	1	0A					
		15	83.2	76.36	60	25.40	1210	1	0.32	-	25.4	1210	0A	0.48
		16	88.3	81.37		25.40	1210	1	0.37	-	25.4	1610	0A	0A
		17	93.3	86.39	71	25.40	1610	1	0.41	-	25.4	1610	0A	0.57
		18	98.3	91.42		25.40	1610	1	0.51		25.4	1610	0A	0A
		19	103.3	96.45	75	25.40	1610	1	0.64	-	25.4	1610	0A	0.71
		20	108.4	101.5		25.40	1610	1	0.68		25.4	1610	0A	0A
		21	113.4	106.5	76	25.40	1610	1	0.73	-	25.4	1610	0A	0.86
		22	118.4	111.6		25.40	1610	1	0.78	-	25.4	1610	0A	0A
		23	123.5	116.6	76	25.40	1610	1	0.82	-	25.4	1610	0A	0.98
		24	128.5	121.6		25.40	1610	1	0.91	90	31.75	2012	0A	0A
		25	133.6	126.7	90	31.75	2012	1	1.09	90	31.75	2012	0A	3.40
		26	138.6	131.7	90	31.75	2012	1	1.14	90	31.75	2012	0A	0A
		27	143.6	136.8	90	31.75	2012	1	1.18	90	31.75	2012	0A	3.50
		28	148.7	141.8	90	31.75	2012	1	1.29	90	31.75	2012	0A	0A
		29	153.7	146.8	0A	0A	2012	1	0A					
		30	158.8	151.9	90	31.75	2012	1	1.41	90	31.75	2012	0A	3.92
		32	168.9	162	90	31.75	2012	1	1.63					
		38	199.1	192.2	90	31.75	2012	1	2.22	90	31.75	2012	0A	5.68
		45	236	227.6	90	31.75	2012	1	2.95					
		57	296.6	288.2	90	31.75	2012	1	4.59	0A	0A	0A	0A	0A
		76	392.5	384.2	110	31.75	2012	1	8.31	0A	0A	0A	0A	0A
		95	488.5	480.1	110	44.45	2517	1	12.76					
		114	584.5	576.1				1						

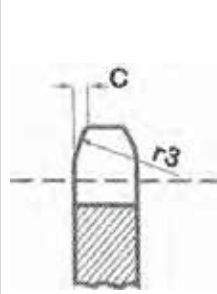

Pinions	mm
Tooth Radius r3	
Radius Width C	
Tooth Width B1	9.1

Chain	mm
Pitch	5.88
Inside	9.65
Roller ø	10.2

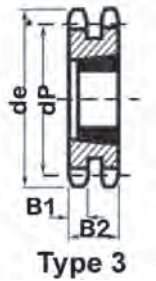
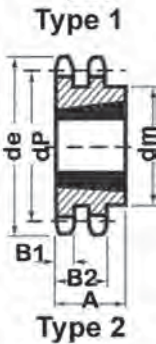
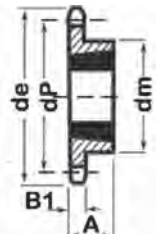

British Standard Taper Locks

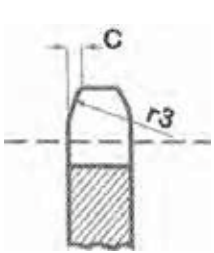
12B-1-2-3 Taper Lock		Teeth	de	dp	dm	A	Bush	Type	App. Kg	dm	A	Bush	Type	App. Kg	dm	A	Bush	Type	App. Kg		
		13	87.8	79.59	60	25.40	1210	1	0.41												
		14	93.6	85.61	70	25.40	1610	1	0A												
		15	99.8	91.63	70	25.40	1610	1	0.54	-	30.10	1610	0A	0.90	-	49.8	1615	5	0A		
		16	105.5	97.65	75	25.40	1610	1	0A	-	30.10	1610	0A	0A							
		17	111.9	103.7	76	25.40	1610	1	0.82	-	30.10	1610	0A	1.25	-	49.8	1615	5	0A		
		18	117.9	109.7	90	31.75	2012	1	0.91	90	31.75	2012	0A	0A							
		19	123.9	115.8	90	31.75	2012	1	1.00	90	31.75	2012	0A	1.81	-	49.8	2012	5	0A		
		20	130	121.8	90	44.45	2517	1	1.00	108	44.45	2517	0A	0A							
		21	136	127.8	102	44.45	2517	1	1.18	108	44.45	2517	0A	2.50	-	49.8	2517	5	0A		
		22	142	133.9	102	44.45	2517	1	1.27	108	44.45	2517	0A	0A							
Pinions	mm	23	148.1	139.9	108	44.45	2517	1	1.37	108	44.45	2517	0A	3.07	-	49.8	2517	5	0A		
Tooth Radius r3		24	154.1	145.9	108	44.45	2517	1	1.50	108	44.45	2517	0A	0A							
Radius Width C		25	160.2	152	108	44.45	2517	1	1.74	108	44.45	2517	0A	3.63	-	49.8	2417	5	0A		
Tooth Width B1	11.1	26	165.9	158	108	44.45	2517	1	0A	108	44.45	2517	0A	0A							
		27	172.3	164.1	108	44.45	2517	1	1.80	108	44.45	2517	0A	4.20	140	50.80	3020	4	0A		
Chain	mm	28	178	170	108	44.45	2517	1	0A	108	44.45	2517	0A	0A							
Pitch	19.05	29	0A	0A	0A	0A	0A	0A	0A	0A	0A	0A	0A								
Inside	11.68	30	190.4	182.3	108	44.45	2517	1	2.32	140	50.80	3020	0A	5.04	140	50.80	3020	4	0A		
Roller ø	12.07	32	202.5	194.4	108	44.45	2517	1	2.48												
		34	0A	0A	0A	0A	0A	0A	0A												
		38	238.9	230.1	108	44.45	2517	1	3.36	140	50.80	3020	0A	8.40	140	50.80	3020	4	0A		
		45	283.2	273.1	108	44.45	2517	1	3.98												
		57	355.9	345.8	124	44.45	2517	1	8.76	0A	50.80	3020	0A	19.48	160	50.80	3020	4	0A		
		76	471.1	461	124	44.45	2517	1	11.68	0A	50.80	3020	0A	29.52	160	50.80	3020	4	0A		
		95	586.2	576.2	0A	44.45	2517	1	14.60	0A	50.80	3020	0A	34.40							
		114	701.4	691.4	0A	44.45	3020	1	17.52	0A	76.20	3030	0A	39.28							

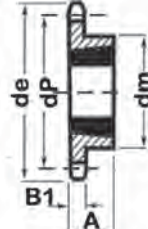
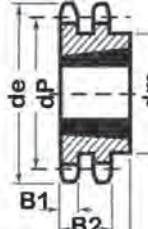
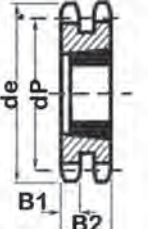
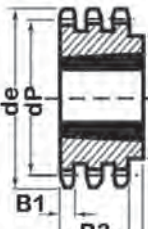
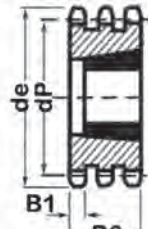
 Type 1	 Type 2	 Type 3	 Type 4	 Type 5
--	--	--	---	--

British Standard Taper Locks



16B-1-2-3 Taper Lock		Teeth	de	dp	dm	A	Bush	Type	App. Kg	dm	A	Bush	Type	App. Kg	dm	A	Bush	Type	App. Kg		
		13	117.7	106.1	73	38.10	1615	1	1.27												
		14	125	114	76	38.10	1610	0A	0A												
		15	133.7	122.2	76	38.10	1615	1	1.45	-	47.7	2012	0A	2.04	-	0A	2012	0A	0A		
		16	141.8	130.2	76	38.10	2012	1	1.55	-	47.7	2517	0A	0A							
		17	149.8	138.2	90	32	2012	1	1.69	-	47.7	2517	0A	2.50	-	79.6	2517	0A	0A		
		18	157.8	146.3	108	44.45	2517	1	1.46	-	47.7	2517	0A	0A							
		19	165.9	154.4	108	44.45	2517	1	2.14	-	47.7	2517	0A	3.18	-	79.6	3030	0A	0A		
		20	173.9	162.4	108	44.45	2517	1	2.72	-	47.7	2517	0A	0A							
		21	182	170.4	110	44.45	2517	1	2.95	140	50.80	3020	0A	2.95	-	79.6	3030	0A	0A		
Pinions	mm	22	190.1	178.5	110	44.45	2517	1	3.18	140	50.80	3020	0A	0A							
Tooth Radius r3		23	198.1	186.5	110	44.45	2517	1	3.40	140	50.80	3020	0A	5.48	159	89	3535	0A	0A		
Radius Width C		24	206.2	194.6	110	44.45	2517	1	3.63	140	50.80	3020	0A	0A							
Tooth Width B1	16.2	25	214.2	202.7	110	44.45	2517	1	3.90	140	50.80	3020	0A	7.72	175	89	3535	0A	0A		
		26	221.6	210.7	110	44.45	2517	0A	0A	140	50.80	3020	0A	0A							
Chain	mm	27	230.4	218.8	110	44.45	2517	1	4.31	140	50.80	302	0A	10.22	175	89	3535	0A	0A		
Pitch	25.4	28	237.7	226.8	110	44.45	2517	0A	0A	140	50.80	3020	0A	0A							
Inside	17.02	29	0A	0A	0A	0A	2517	0A	0A	140	50.80	3020	0A	0A							
Roller ø	15.88	30	254.6	243	120	44.45	2517	1	5.44	140	50.80 76.20	3020 /3030	2	11.35	175	89	3535	0A	0A		
		35	294.9	283.4	0A	50.80	3020	1	7.12												
		38	319.2	307.6	160	50.80	3020	1	8.85	160	76.20	3030	2	21.79	178	89	3535	0A	0A		
		45	377.9	364.1	0A	50.80	3020	1	12.25												
		57	474.9	461.1	0A	50.80	3020	1	19.16		86.90	3535	2	27.24	216	102	4040	0A	0A		
		76*	628.4	614.7	0A	50.80	3020	1	28.55		86.90	3535	2	37.68	216	102	4040	0A	0A		
		95	782	768.2	0A	50.80	3020	0A	41.58												
		114	935.6	921.8	0A	50.80	3020	0A	56.15												

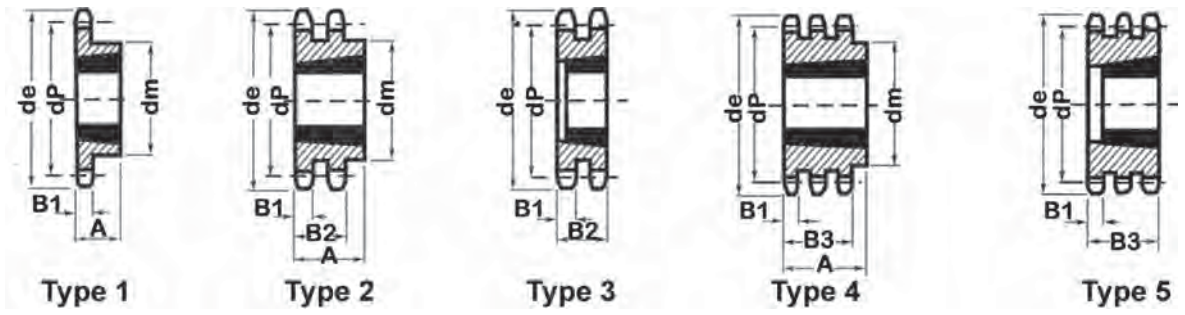



British Standard Plate Wheels

06A-1 Plate Wheel

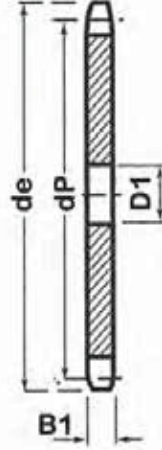
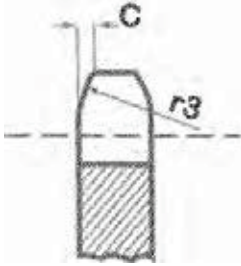

Pinions	mm
Tooth Radius r3	
Radius Width C	
Tooth Width B1	5.3
Chain	mm
Pitch	9.525
Inside	5.72
Roller ϕ	6.35

Teeth	de	dp	D1	App. Kg
11	37.5	33.8	8	0.05
12	40.5	36.8	8	0.05
13	43.5	39.8	8	0.05
14	46.5	42.8	8	0.06
15	49.5	45.81	8	0.07
16	52.5	48.82	10	0.08
17	55.5	51.83	10	0.10
18	58.6	54.85	10	0.11
19	61.6	57.87	10	0.12
20	64.6	60.89	10	0.13
21	67.6	63.91	12	0.14
22	70.6	66.93	12	0.15
23	73.7	69.95	12	0.17
24	76.7	72.97	12	0.19
25	79.7	76	12	0.20
26	82.7	79.02	12	0.21
27	85.7	82.04	12	0.22
28	88.8	85.07	12	0.23
29	91.8	88.09	12	0.25
30	94.8	91.12	12	0.27
31	97.9	94.15	14	0.22
32	100.9	97.17	14	0.24
33	103.9	100.2	14	0.25
34	106.9	103.2	14	0.26
35	110	106.3	14	0.27
36	113	109.3	16	0.28
37	116	112.3	16	0.35
38	119	115.3	16	0.43
39	122.1	118.4	16	0.44
40	125.1	121.4	16	0.45
45	118.6	114.7	16	0.51
57	149.3	145.2	20	0.86

British Standard Plate Wheels



Bearings &
Power Transmission Pty Ltd
(Phone) 07 4636 0522

SPROCKETS

08A-1 Plate Wheel

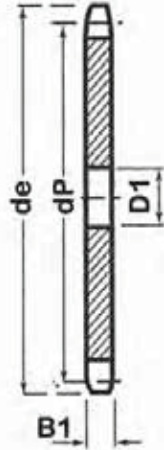
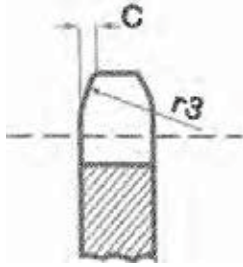

Pinions	mm
Tooth Radius r3	
Radius Width C	
Tooth Width B1	7.2
Chain	mm
Pitch	12.7
Inside	7.75
Roller \varnothing	8.51

Teeth	de	dp	D1	App. Kg
10	43		8	0A
11	49.9	45.07	10	0.06
12	53.9	49.07	10	0.08
13	57.9	53.06	10	0.10
14	61.9	57.07	10	0.12
15	65.9	61.09	10	0.14
16	69.9	65.1	12	0.15
17	74	69.11	12	0.16
18	78	73.14	12	0.2
19	82	77.16	12	0.21
20	86	81.19	12	0.25
21	90.1	85.22	14	0.26
22	94.1	89.24	14	0.30
23	98.1	93.27	14	0.33
24	102.1	97.29	14	0.37
25	106.2	101.3	14	0.40
26	110.2	105.4	16	0.43
27	114.2	109.4	16	0.44
28	118.3	113.4	16	0.50
29	112.3	117.5	16	0.55
30	126.3	121.5	16	0.57
31	130.4	125.5	16	0.64
32	134.4	129.6	16	0.67
33	138.4	133.6	16	0.71
34	142.5	137.6	16	0.74
35	146.5	141.7	16	0.77
36	150.6	145.7	16	0.83
37	154.6	149.8	16	0.87
38	158.6	153.8	16	0.91
39	162.7	157.8	16	0.92
40	166.7	161.9	16	1.01
42	176.5	170	20	1.13
45	188.6	182.1	20	1.43
48	200.7	194.2	20	1.46
50	208.8	202.3	20	1.80
55	229	222.5	20	2.10
57	233.1	230.5	20	2.27
60	249.2	242.7	20	2.37
65	269.4	262.86	25	2.17
70	289.6	283.07	25	3.10
76	313.9	307.3	25	3.50

10A-1 Plate Wheel

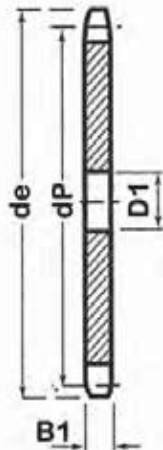
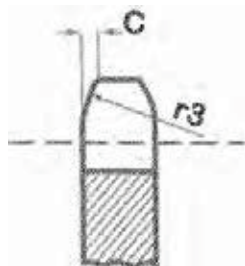

Pinions		mm
Tooth Radius r3		
Radius Width C		
Tooth Width B1		9.1
Chain		mm
Pitch		5.88
Inside		9.65
Roller ϕ		10.2

Teeth	de	dp	D1	App. Kg
11	63.2	56.35	12	0.11
12	68.2	61.34	12	0.15
13	73.2	66.32	12	0.19
14	78.2	71.34	12	0.23
15	83.2	76.36	12	0.25
16	88.3	81.37	12	0.31
17	93.3	86.39	12	0.35
18	98.3	91.42	14	0.39
19	103.3	96.45	14	0.43
20	108.4	101.5	14	0.48
21	113.4	106.5	16	0.51
22	118.4	111.6	16	0.59
23	123.5	116.6	16	0.65
24	128.5	121.6	16	0.68
25	133.6	126.7	16	0.73
26	138.6	131.7	20	0.78
27	143.6	136.8	20	0.89
28	148.7	141.8	20	0.93
29	153.7	146.8	20	1.07
30	158.8	151.9	20	1.15
31	163.8	156.9	20	1.27
32	168.9	162	20	1.32
33	173.9	167	20	1.42
34	178.9	172.1	20	1.45
35	184	177.1	20	1.51
36	189	182.2	20	1.73
37	194.1	187.2	20	1.81
38	199.1	192.2	20	1.88
39	204.2	197.3	20	2.00
40	209.2	202.3	20	2.02
42	220.8	212.4	25	2.26
45	236	227.6	25	2.69
48	251.1	242.7	25	2.98
50	261.2	252.8	25	3.22
52	270.4	262.92	20	0A
55	286.5	278.1	25	3.88
57	296.6	288.2	25	4.25
60	311.7	303.3	25	4.90
65	337.0	328.58	25	5.50
70	362.2	353.84	25	6.35
72	372.3	363.95	25	6.91
76	392.5	384.2	25	9.11

British Standard Plate Wheels

12A-1 Plate Wheel		Teeth	de	dp	D1	App. Kg
		11	75.8	67.61	16	0.36
		12	81.8	73.6	16	0.42
		13	87.8	79.59	16	0.48
		14	93.8	85.61	16	0.54
		15	99.8	91.63	16	0.60
		16	105.8	97.65	16	0.68
		17	111.9	103.7	16	0.77
		18	117.9	109.7	16	0.85
		19	123.9	115.8	16	0.95
		20	130	121.8	16	1.08
		21	136	127.8	20	1.15
		22	142	133.9	20	1.24
		23	148.1	139.9	20	1.33
		24	154.1	145.9	20	1.47
		25	160.2	152	20	1.63
		26	166.2	158	20	1.72
		27	172.3	164.1	20	1.91
		28	178.3	170.1	20	1.99
		29	184.4	176.2	20	2.28
		30	190.4	182.3	20	2.44
		31	196.5	188.3	20	2.49
		32	202.5	194.4	20	2.62
		33	208.6	200.4	20	2.77
		34	214.6	206.5	20	2.91
		35	220.7	212.5	20	3.19
		36	226.8	218.6	25	3.21
		37	232.8	224.6	25	3.52
		38	238.9	230.1	25	3.67
		39	244.9	236.8	25	3.87
		40	251	242.8	25	4.00
		42	265	254.9	25	4.53
		45	283.2	273.1	25	5.14
		48	301.4	291.3	25	5.75
		50	313.5	303.4	25	6.45
		55	343.8	333.7	25	7.43
		57	355.9	345.8	25	8.11
		60	374.1	364	25	9.19
		65	404.4	394.29	25	10.65
		70	434.7	424.60	30	12.45
		72	446.8	436.74	30	13.22
		76	471.1	461	30	14.78

Pinions		mm
Tooth Radius r3		
Radius Width C		
Tooth Width B1		11.1

Chain		mm
Pitch		19.05
Inside		11.68
Roller ø		12.07

16A-1 Plate Wheel

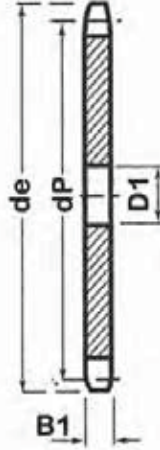
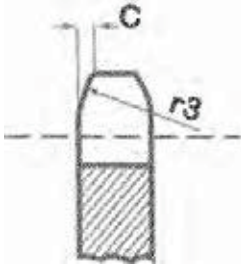

Pinions	mm
Tooth Radius r3	
Radius Width C	
Tooth Width B1	16.2
Chain	mm
Pitch	25.4
Inside	17.02
Roller \varnothing	15.88

Teeth	de	dp	D1	App. Kg
11	101.7	90.14	16	0.82
12	109.7	98.14	16	0.91
13	117.7	106.1	16	1.04
14	125.7	114.2	16	1.22
15	133.7	122.2	16	1.36
16	141.8	130.2	20	1.54
17	149.8	138.2	20	1.81
18	157.8	146.3	20	2.00
19	165.9	154.4	20	2.13
20	173.9	162.4	20	2.49
21	182	170.4	20	2.63
22	190.1	178.5	20	2.82
23	198.1	186.5	20	3.04
24	206.2	194.6	20	3.45
25	214.2	202.7	20	3.63
26	222.3	210.7	20	3.90
27	230.4	218.8	20	4.31
28	238.4	226.9	20	4.58
29	246.5	234.9	20	4.81
30	254.6	243	20	5.22
31	262.6	251.1	25	5.56
32	270.7	259.1	25	5.90
33	278.8	267.2	25	6.24
34	286.9	275.3	25	6.58
35	294.9	283.4	25	6.92
36	303	291.4	25	7.26
37	311.1	299.5	25	7.60
38	319.2	307.6	25	7.94
39	327.2	315.7	25	8.48
40	335.3	323.4	25	9.01
45	377.9	364.1	25	11.70
57	474.9	461.1	30	18.14

Weld Fit Welded Hubs and Sprockets

Welded Hubs For use with Welded Sprockets	VT Series Hub		WT Series Hub		XT Series Hub	
	For VT sprockets		For WT sprockets		For XT sprockets	
A	34mm	(1-5/16)	45mm	(1-3/4)	62mm	(2-7/16)
B	30mm	(1-3/16)	41mm	(1-5/8)	57mm	(2-1/4)
C	12mm	(1/2)	12mm	(1/2)	12mm	(1/2)
D	30mm	(1-3/16)	37mm	(1-7/16)	37mm	(1-7/16)

BORE							
Inch		mm		Inch		mm	
1/2	12	14	14	1/2	12	14	
	15				15		
5/8	16	16	16	5/8	15	16	
	18				18		
3/4	19	19	19	3/4	18	19	
	20				20		
7/8	22	22	22	7/8	20	22	
	24				24		
1	25	25	25	1	24	25	
	28				28		
1-1/8	30	30	30	1-1/8	28	30	
	32				32		
1-1/4	35	35	35	1-1/4	32	35	
	38				38		
1-3/8	40	40	40	1-3/8	38	40	
	42				42		
1-1/2	45	45	45	1-1/2	42	45	
	48				48		
1-5/8	50	50	50	1-5/8	45	50	
	52				52		
1-3/4	55	55	55	1-3/4	52	55	
	58				58		

Welded Hubs and Sprockets

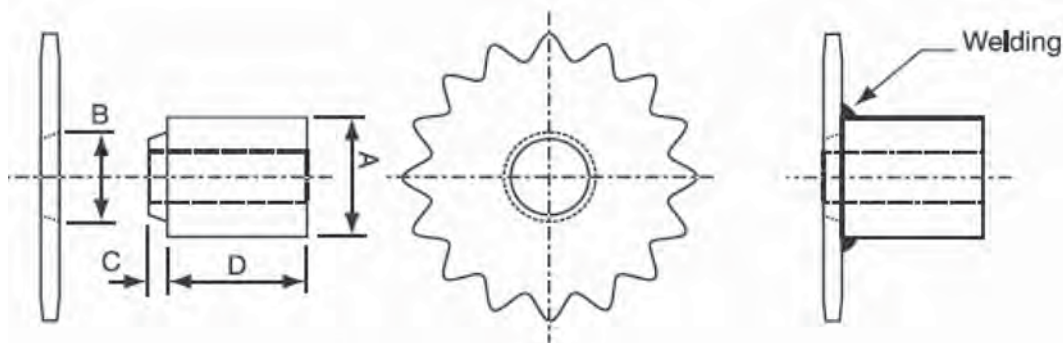

Notes

- 1) Welding with low hydrogen electrodes is recommended
- 2) Keyways conform to BS 46 (imperial) and BS 4235 (metric)



Weld Fit Welded Hubs and Sprockets

ANSI & BS Palte Wheel Sprockets

with prepared Taper bore to receive welded hubs

No. of Teeth	08B1 1/2" Pitch	ANSI-40 1/2" Pitch	ANSI-50 BS 10B 5/8" Pitch	ANSI-60 BS 12B 3/4" Pitch	ANSI-80 BS 16B 1" Pitch
12	08V12HT	40VT12HT	50WT12HT	60WT12HT	80XT12HT
13	08V13HT	40VT13HT	50WT13HT	60WT13HT	80XT13HT
14	08V14HT	40VT14HT	50WT14HT	60WT14HT	80XT14HT
15	08V15HT	40VT15HT	50WT15HT	60XT15HT	80XT15HT
16	08WT16HT	40WT16HT	50WT16HT	60XT16HT	80XT16HT
17	08WT17HT	40WT17HT	50XT17HT	60XT17HT	80XT17HT
18	08WT18HT	40WT18HT	50XT18HT	60XT18HT	80XT18HT
19	08WT19HT	40WT19HT	50XT19HT	60XT19HT	80XT19HT
20	08XT20HT	40XT20HT	50XT20HT	60XT20HT	80XT20HT
21	08XT21HT	40XT21HT	50XT21HT	60XT21HT	80XT21HT
22	08XT22HT	40XT22HT	50XT22HT	60XT22HT	80XT22HT
23	08XT23HT	40XT23HT	50XT23HT	60XT23HT	80XT23HT
24	08XT24HT	40XT24HT	50XT24HT	60XT24HT	80XT24HT
25	08XT25HT	40XT25HT	50XT25HT	60XT25HT	80XT25HT
26	08XT26HT	40XT26HT	50XT26HT	60XT26HT	80XT26HT
27	08XT27HT	40XT27HT	50XT27HT	60XT27HT	80XT27HT
28	08XT28HT	40XT28HT	50XT28HT	60XT28HT	80XT28HT
29	08XT29HT	40XT29HT	50XT29HT	60XT29HT	80XT29HT
30	08XT30HT	40XT30HT	50XT30HT	60XT30HT	80XT30HT
32	08XT32HT	40XT32HT	50XT32HT	60XT32HT	80XT32HT
34	08XT34HT	40XT34HT	50XT34HT	60XT34HT	80XT34HT
36	08XT36HT	40XT36HT	50XT36HT	60XT36HT	80XT36HT
38	08XT38HT	40XT38HT	50XT38HT	60XT38HT	80XT38HT
40	08XT40HT	40XT40HT	50XT40HT	60XT40HT	80XT40HT
45	08XT45HT	40XT45	50XT45HT	60XT45HT	80XT45HT
57	08XT57HT	40XT57	50XT57 HT	60XT57HT	80XT57HT
76	08XT76HT	40XT76HT	50XT76HT	60XT76HT	80XT76HT