

Dimensions

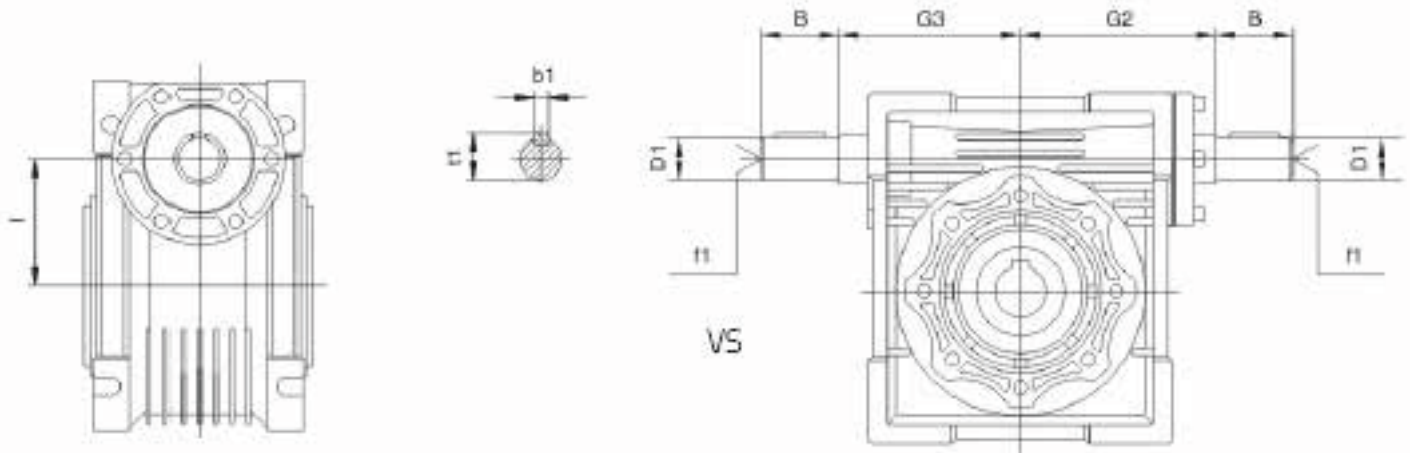

NMRV	G2	G3	D1	B	F1	l	b1	t1
030	51	45	9j6	20	-	30	3	10.2
040	60	53	11j6	23	-	40	4	12.5
050	74	64	14j6	30	M6	50	5	16
063	90	75	19j6	40	M6	63	6	21.5
075	105	90	24j6	50	M8	75	8	27
090	125	108	24j6	50	50	90	8	27

Dimensions - Low Speed Shafts

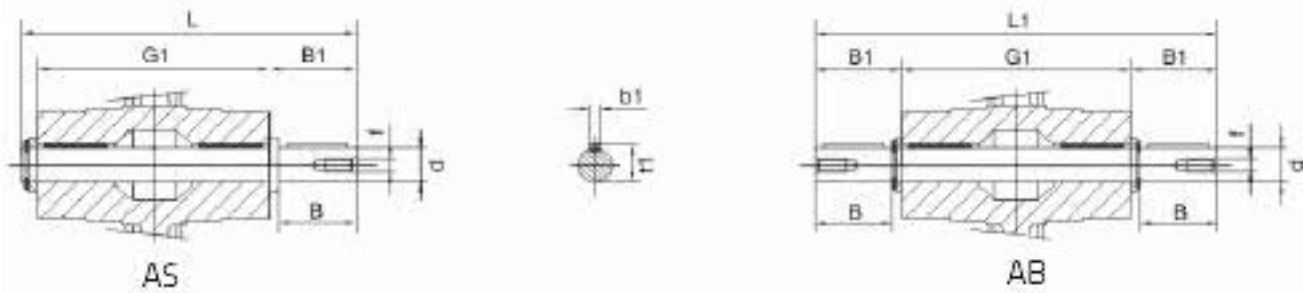

NMRV	d	B	B1	G1	L	f	b1	t1
030	14 g6	30	32.5	63	102	M6	5	16
040	18 h6	40	43	78	128	M6	6	20.5
050	25 h6	50	53.5	92	153	M10	8	28
063	25 h6	50	53.5	112	173	M10	8	28
075	28 h6	60	63.5	120	192	M10	8	31
090	35 h6	80	84.5	140	234	M12	10	38