

6. Installation

Type H

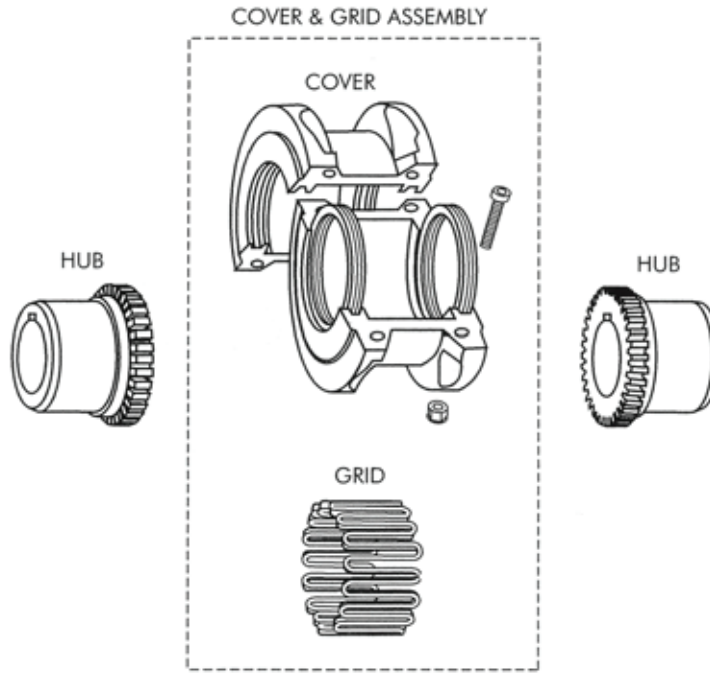

Type V

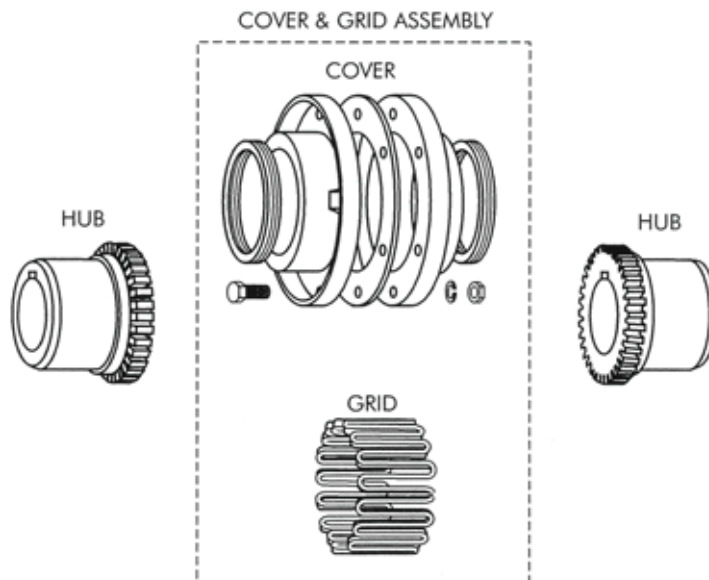



BPT Grid Coupling

7. Installation

KSAS

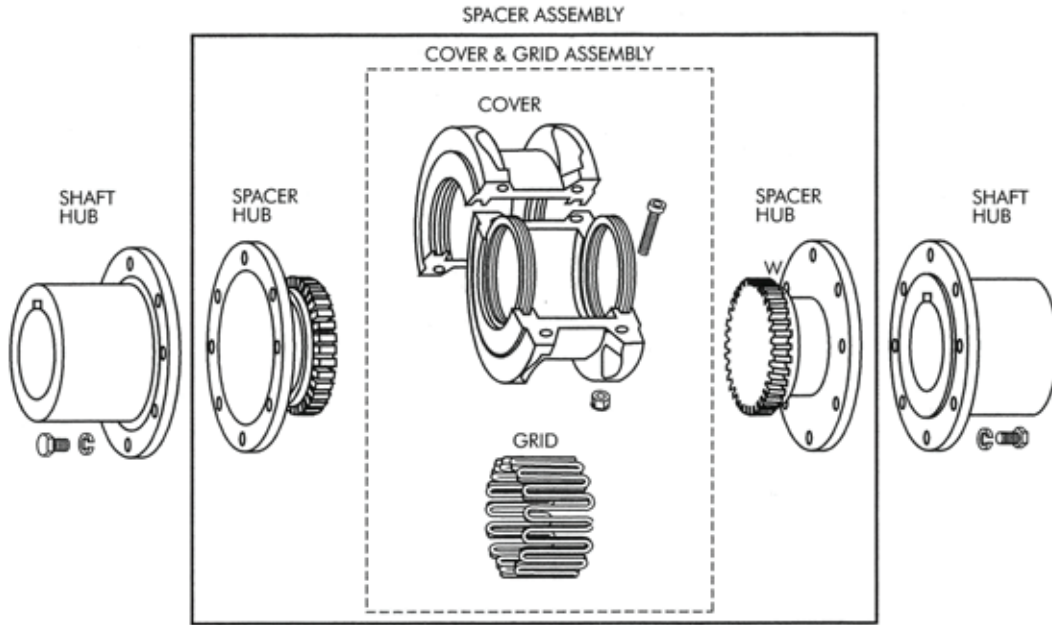

KSFS

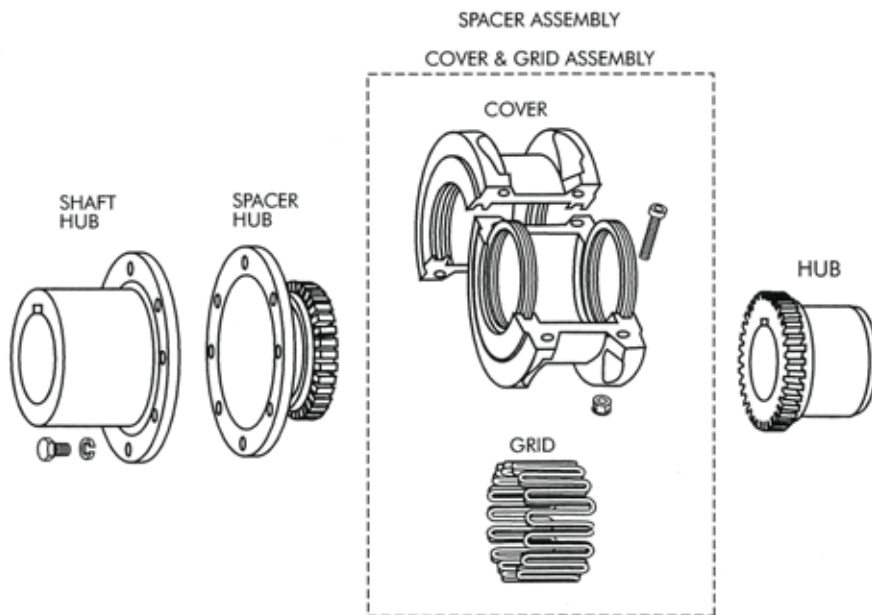

9. Lubrication and Handling

Choose high quality lubricant for KCP Taper Grid Couplings for good performance and long life.

1. Grease Lubrication

Grease on the grid & hub teeth before assembling covers.

Fill up grease through the lub plug of the assembled coupling.

2. Supplement

Every three month Every 240~250 hours operating, you should add grease.

3. Replacement

Every 3 months, or every 4,000 hours operating you should replace all the deteriorated grease.

4. Selection

Choose grease according to the ambient temperature range in table 5.

☒ Common Industrial Lubricants(NYGL Grade #2)

Table5

Manufacture	Ambient Temperature Range:	
	0° F to 150° F (-18° C to 66° C)	-30° F to 100° F (-34° C to 38° C)
Amoco Oil Co.	Amolith Grease #2	Amolith Grease #2
Atlantic Richfield co.	Litholene HEP 2	Litholene HEP 2
Chevron U.S.A Inc.	Chevron Dura-Lith EP-2	Chevron Dura-Lith EP-2
Cities Service Co.	Citgo HEP-2	Citgo HEP-2
Conoco Inc.	EP Conolith #2	EP Conolith #2
Exxon Company, USA	Ronex MP	Ronex MP
Gulf Oil Corp.	Gulfcrown Grease #2	Gulfcrown Grease #2
E.F.Houghton & Co.	Cosmolube #2	Cosmolube #1
Imperial Oil Ltd.	Esso MP Grease H	Lotemp EP
Keystone Div.(Pennwalt)	#81 Light	#84 Light
Mobil Oil Corp.	Mobilux EP111	Mobilux #1
Phillips Petroleum Co.	IB & RB grease	Philube IB & RB grease
Shell Oil Co.	Alvania Grease #2	Alvania Grease #2
Standard Oil Co.(OH)	Factran #2	Factran #2
Sun Oil Company	Prestige 42	Prestige 42
Texaco Lubricants	Starplex HD 2	Multifac EP2
Union Oil Co.(CA)	Union Undoba #2	Union Undoba #2
Valvoline Oil Co.	Val-Lith EP #2	Val-Lith EP #2

☒ Note: For feed processing in dustry, check with lube manufacture for approved lubricants.